

CARMEL VALLEY PARK & RECREATION COUNCIL

San Diego Park & Recreation Department Carmel Valley Recreation Council

October 1, 2000

Park Improvements Listing:

- M-1 Carmel Valley Area Map
- M-2 Carmel Valley Community Park - Neighborhood 9
- M-3 C.V. Community Park Site Plan
- M-4 Solana Highlands Park - Neighborhood 3
- M-5 Carmel Del Mar Park - Neighborhood 5
- M-6 Carmel Creek Park - Neighborhood 1
- M-7 Carmel Grove Park - Neighborhood 6
- M-8 Carmel Mission Park (a.k.a. Powerline Park) - Neighborhood 1
- M-9 Carmel View Park - Neighborhood 6
- M-10 Del Mar Trails Park - Neighborhood 5
- M-11 Torrey Highlands Park - Neighborhood 7
- M-12 Winwood Park - Neighborhood 1
- M-13 Ashley Falls Park (not all elements improved at this time) - Neighborhood 4
- M-14 Torrey Hills Park - Sorrento Hills/Torrey Hills Community - West of 8A
- M-15 Carmel Knolls Park (not improved at this time) – Neighborhood 1
- M-16 Sage Canyon neighborhood Park (not improved at this time) – Neighborhood 10

Carmel Valley Community Park

18.8 Acre Site - Approximately 13 Useable Acres

Joint Use Agreement with San Dieguito Union High School District

Recreation Building: 1 Game/Arts & Crafts Room
1 Meeting Room w/attached Warming Kitchen
1 11,000 sf. Gymnasium - ability to divide with drop curtain

Swimming Pool: 1 Small Pool with Play Structure for Younger
1 Large Pool with 0" Depth Entry
1 Learn-to-Swim/Slide Receiving Pool
1 Water Slide Tower w/2 Tubes - 1 open/1 enclosed

Lower & Upper Parking Lots

2 Baseball/Softball Fields OR 1 Soccer/Multi-Purpose Field

Night Ballfield Lighting

Tot Lot for Youth - to age 12

Play Structure for Teens

Outdoor Amphitheater w/Stage & Lawn Seating

4 Lighted Tennis Courts

Outdoor Basketball Court

Comfort Station

Drinking Fountain

Fitness Area

2 Horseshoe Pits

Open Grass Play Area

Lawn Picnic Area

Plaza Picnic Area

Benches & Bike Racks

Solana Highlands Park

Approximately 12 Acres

Joint Use Agreement with Solana Beach School District

Perimeter Fencing

2 Parking Lots

2 Baseball/Softball Fields OR 1 Soccer/Multi-Purpose Field

Outdoor Hardcourt Area with Ball-wall and Basketball Courts

Restrooms

Drinking Fountain

Tot Lot for Youth - to age 12

Benches & Bike Racks

Open Grass Play Area

Grassy Picnic Area w/BBQ'S

Carmel Del Mar Park

Approximately 12 Acres

Joint Use Agreement with Del Mar Union School District

Perimeter Fencing

Parking Lot

1 Baseball/Softball Field OR 1 Soccer/Multi-Purpose Field

1 T-ball Field

Grassy Area Between Ballfields- Will Fit 2 Small T-ball Fields with Temporary Backstops

Outdoor Hardcourt Area with Ball-wall and Basketball Courts

2 Play Structures (Both installed and paid for by Del Mar Union School Distr.)

2 Unisex Restrooms

Drinking Fountain

Tot Lot for Youth - to age 12

Benches & Bike Racks

Picnic Area w/BBQ'S

Carmel Creek Park

Approximately 12 Acres
Joint Use Agreement with Solana Beach School District
Perimeter Fencing
Parking Lot
2 Baseball/Softball Fields **OR** 1 Soccer/Multi-Purpose Field
1 Small Soccer/Multi-Purpose Field
Outdoor Hardcourt Area with Basketball Courts
1 Primary Play Structure
1 Play Structure (installed and paid for by Solana Beach School Distr.)
1 Comfort Station
Drinking Fountain
Sand Volleyball Court
Benches & Bike Racks
Picnic Area w/BBQ'S

Carmel Grove Park

Approximately 3 Acres
Perimeter Fencing
Perimeter Walking Path
Tot Lot for Youth - to age 12
Open Grass Play Area
Drinking Fountain
Picnic Area w/BBQ'S
Benches & Bike Racks
Street Parking Available

Carmel Mission Park (a.k.a. Powerline Park)

Approximately 5.75 Acres
2 Separate Grass Play Areas (North & South of Carmel Center Road)
Drinking Fountain
Benches
Perimeter Walking Path
Equestrian Trail
Street Parking Available

Carmel View Park

Approximately .9 Acre
Perimeter Walking Path
Benches
Open Grass Play Area
No - Street Parking Available

Del Mar Trails Park

Approximately 3 Acres
Perimeter Fencing
Perimeter Walking Path
Open Grass Play Area
Tot Lot for Youth - to age 12
Half-Court Basketball
Drinking Fountain
Picnic Area w/BBQ'S
Benches & Bike Racks
Limited Street Parking Available

Torrey Highlands Park

Approximately 7 Acres
Perimeter Fencing
Walking Path (Leads to Nature Trail at North End of Park)
2 Separate Tot Lot Areas for Youth - to age 12
Large Open Grass Play Area
Comfort Station
Drinking Fountain
Picnic Area w/BBQ'S
Benches & Bike Racks
Parking Lot

Winwood Park

Approximately 1.25 Acres
Perimeter Walking Path
Tot Lot for Youth - to age 12
Drinking Fountain
Picnic Tables, Benches & Bike Racks
Street Parking Available

Ashley Falls Park (Note: items indicated with an (*) are not improved at this time)

Approximately 12 Acres
Joint Use Agreement with Del Mar Union School District
Perimeter Fencing
2 T-ball Fields **OR** 1 Small Soccer/Multi-Purpose Field
Outdoor Hardcourt Area with Basketball Courts
1 Play Structure (installed and paid for by Del Mar Union School Distr.)
Parking Lot
* 2 Baseball/Softball Fields **OR** 1 Soccer/Multi-Purpose Field
* 1 Primary Play Structure
* 1 Comfort Station
* Drinking Fountain
* Benches & Bike Racks
* Picnic Area w/BBQ'S
* Sand Volleyball Court

Torrey Hills Park

Approximately 10 Acres
Perimeter Fencing
Perimeter Walking Path
Night Ballfield Lighting
2 Baseball/Softball Fields **OR** 1 Soccer/Multi-Purpose Field
1 Soccer/Multi-Purpose Field
Basketball Court
Comfort Station
Drinking Fountain
Play Structure
Parking Lot
Possible Joint-Use with YMCA - 4 acres

Carmel Knolls Park (not improved at this time)

Approximately 5 Acres

Perimeter Fencing

Perimeter Walking Path

2 Separate Tot Lot Areas for Youth - to age 12

Half-Court Basketball

3-Hole Frisbee Golf Course

Large Open Grass Play Area

Drinking Fountain

Picnic Area w/BBQ'S

Benches & Bike Racks

Parking Lot

Sage Canyon Neighborhood Park (Note: items indicated with an (*) are not improved at this time)

Approximately 12 Acres

Joint Use Agreement with Del Mar Union School District

Perimeter Fencing

2 T-ball Fields **OR** 1 Small Soccer/Multi-Purpose Field

Outdoor Hardcourt Area with Basketball Courts

1 Play Structure (installed and paid for by Del Mar Union School Distr.)

School Owned Parking Lot

* Park Use Parking Lot

* 2 Baseball/Softball Fields **OR** 1 Soccer/Multi-Purpose Field

* 1 Primary Play Structure

* 1 Comfort Station

* Drinking Fountain

* Benches & Bike Racks

* Picnic Area w/BBQ'S

* Sand Volleyball Court

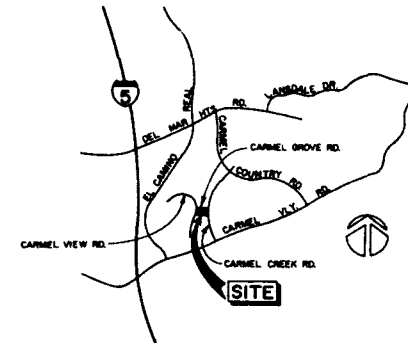
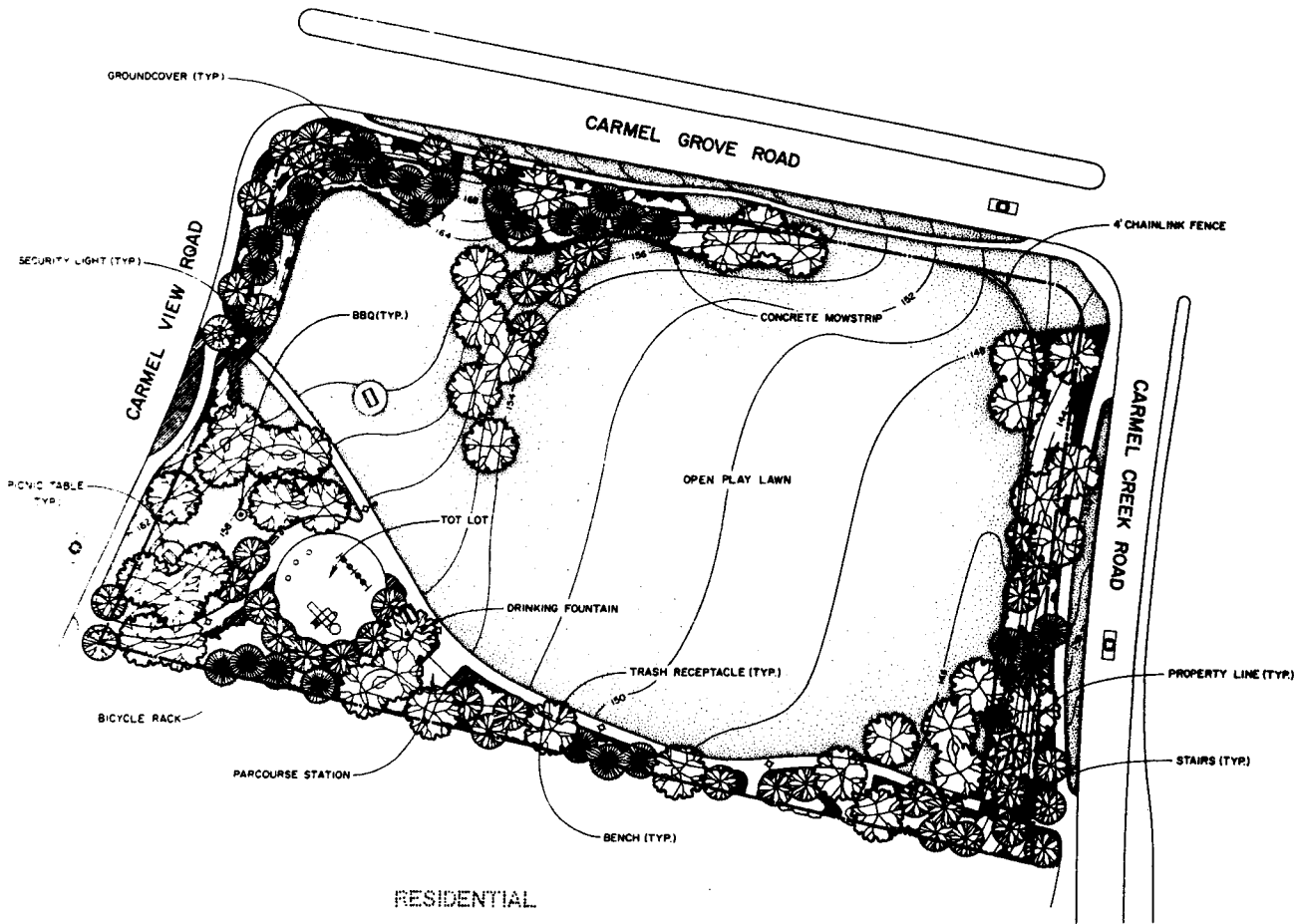

Vicinity Map

DATA LOG FOR:				
DATE	ACTION	REFERENCE DOCUMENTS		
	SITE ACQUIRED	PSD NO	CD# 1	ACRES
	SITE DEDICATED	OSD NO		ACRES
PRIVATE	OSD CONSULTANT Hired	PSD NO BY BALDWIN CO.	NAME ESTRADA LAND PLANNING	
6-18-87	PA & BOARD APPROVAL	PP&R APPROVAL		
10-24-88	INITIAL DEVELOPMENT	CIP NO	JD NO 870478	DRWG NO 24130-D
		CIP NO	JD NO	DRWG NO
		CIP NO	JD NO	DRWG NO
		CIP NO	JD NO	DRWG NO
		CIP NO	JD NO	DRWG NO
		CIP NO	JD NO	DRWG NO

IMPROVEMENTS SUMMARY (DATA FROM AS-BUILT DRAWINGS)					
ITEM	QUANTITY	ITEM	QUANTITY	ITEM	QUANTITY
TOTAL SITE	3.00 AC	PLAY AREA	2,830 SF	PAVED WALKS	11,842 SF
IMPROVED AREA	3.00 AC	MULTI PURPOSE CT	5P	PAVED ROADS	5P
IMP	2.80 AC	TENNIS CT	5P	PARKING LOT	5P
SHRUB BED	AC	RESTROOM	5P	STALLS STD	MULTI PURPOSE CT
NATURAL	AC	SEC BLDG	5P	STALLS HOCP	
GROUNDCOVER	87 AC	FOOD BLDG	5P	COURT GAME AREA	5P
CBY WIELDS	AC	DECK	5P	TENNIS CT	5A
BBQ	2 EA	WATER	5P	LAWN EDGING	2,160 LF
BICYCLE RACK	1 EA	PICNIC TABLES	4 EA	PARCOURSE	3 STA
				DRINKING FOUNTAIN	1 EA
				BENCHES	3 EA
				REVISION	T.R. 1-31-87

CITY OF SAN DIEGO PARK and RECREATION DEPARTMENT

THE GENERAL DEVELOPMENT PLAN
CARMEL GROVE
 OPEN SPACE RENAISSANCE PARK

COUNCIL DIST NO 1 COMM PLAN AREA NORTH CITY WEST - 24 PSD NO
 LAMBERT COORDINATES 282-M97 THOMAS BROS PG 34, C-4 190

M-7

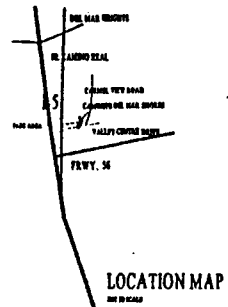

PLANTING LEGEND

SYMBOL	DESCRIPTION	PLANTING SIZE
TREES		
(7)	ACQUIT TREE SUCH AS: NEW ZEALAND CHRISTMAS TREE PURPLE LEAF PLUM PINKYLLAETHRA	100% # 24" HIGH PLANT 100% # 24" HIGH STD.
(A)	SHRUBS/SPREADERS TREES SUCH AS: FICUS POLYCARPA AUSTRALIAN WILLOW LAMB EARS	100% # 24" HIGH STD. 100% # 24" HIGH STD. 100% # 24" HIGH STD.
(8)	SHRUBS TREES TO PERMANENT SCALE TYPE CANARY ISLAND PINE	100%
SHRUBS/GRASSCOVERS		
(4)	ACQUIT SHRUBS/TREES SUCH AS: DWARF PALM LIT OF THE HILL BOULDERVILLEA - VINE FORM	100% # 1 GAL. 10" O.C. 100% # 1 GAL. 10" O.C. 100% # 1 GAL. 10" O.C.
(5)	SHRUBS SUCH AS: LANTANA MILKWEED MILKWEED CONCRETE-ASTER TWIG	100% # 1 GAL. 10" O.C. 100% # 1 GAL. 10" O.C.
(6)	CARNAS BUSHES OF ANY SIZE FROM HARDY TO TALLER	100% # 1 GAL. 10" O.C. 100% # 1 GAL. 10" O.C.
(9)	SHRUBS & GRASSCOVERS HOLDING PERMANENT ACQUIS NEW ZEALAND PLUM MIX - PAUP MIX	100%

IRRIGATION NOTES:

- ALL IRRIGATION WORK SHALL COMPLY WITH THE SAN DIEGO LANDSCAPE TECHNICAL MANUAL, SECTION FIVE - IRRIGATION SYSTEMS.
- THE SYSTEM SHALL BE A LOW-PRECIPITATION SPRAY OR BUBBLER TYPE SYSTEM WHICH INCLUDES THE FOLLOWING DESIGN FEATURES:
 - AN APPROVED BACKFLOW PREVENTION DEVICE
 - AN AUTOMATIC CONTROLLER WITH BATTERY BACKUP FEATURES
 - SEPARATED VALVES FOR DIFFERENT SOLAR EXPOSURES, SLOPES, AND SOILS
 - RAIN SHUT-OFF AND FLOWING SENSING DEVICES

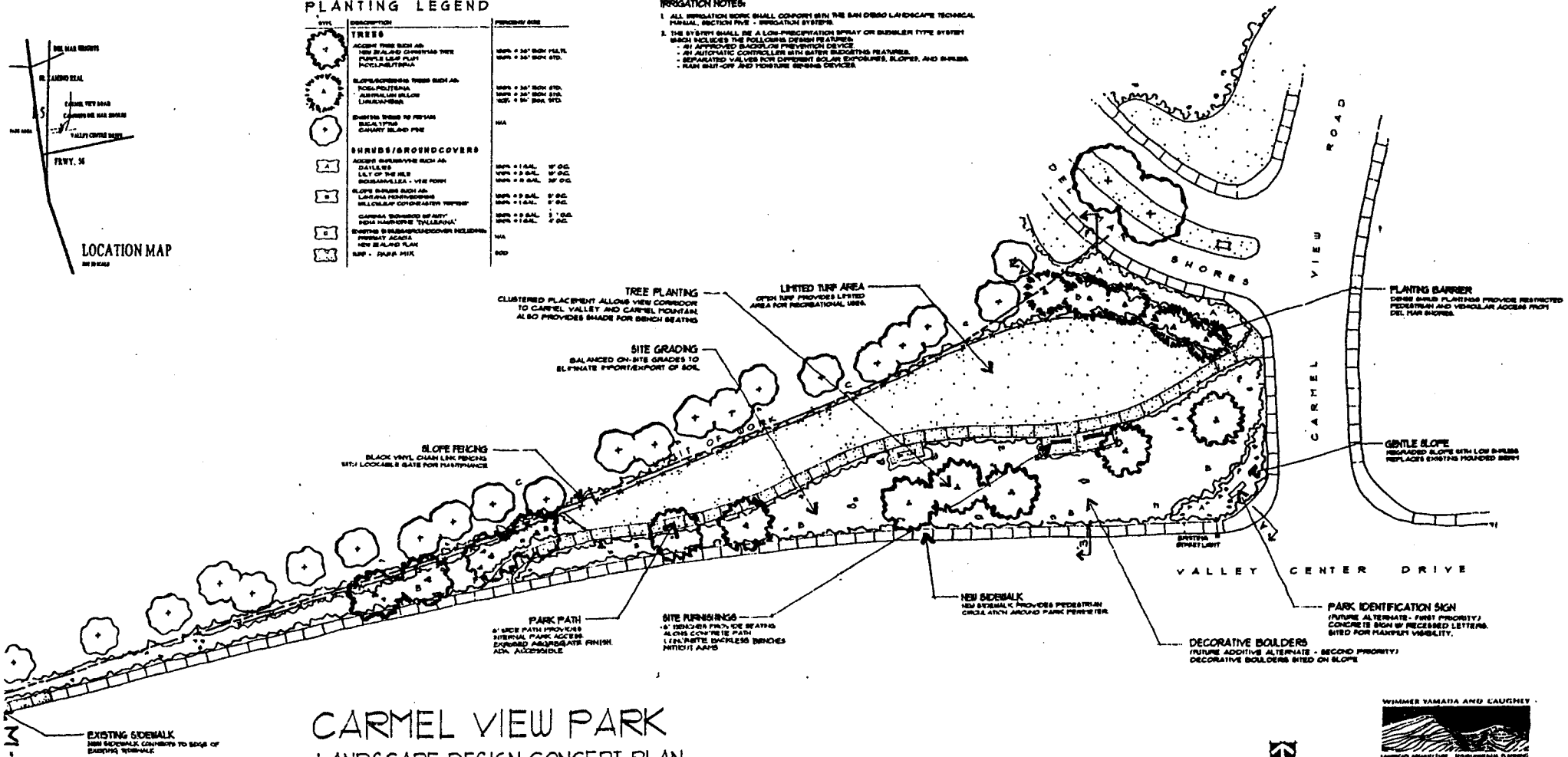

CARMEL VIEW PARK
LANDSCAPE DESIGN CONCEPT PLAN



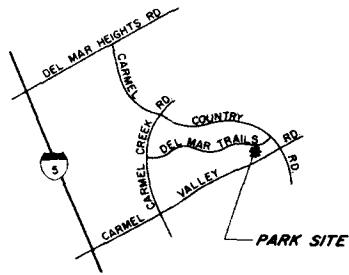

LOCATION MAP

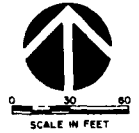
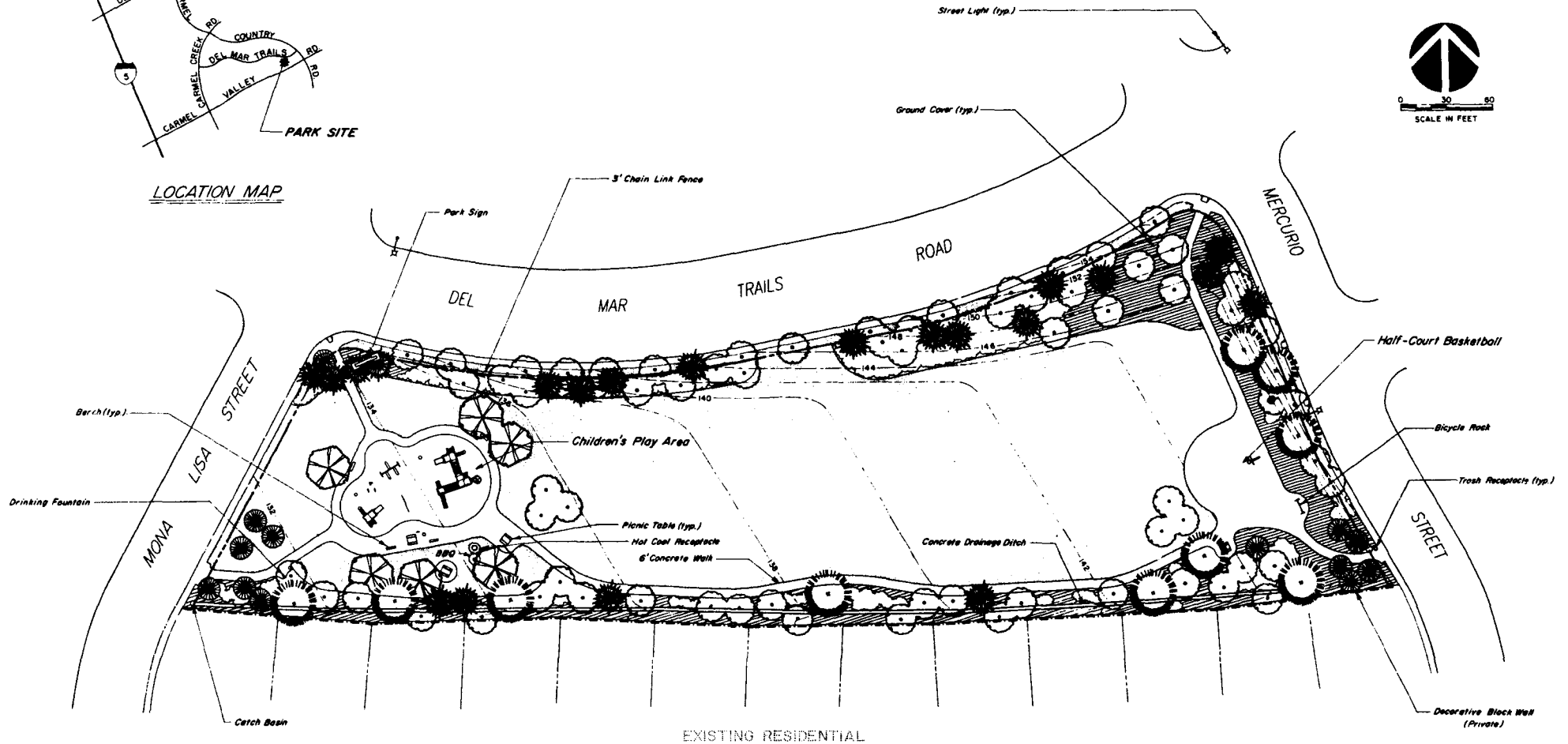

EXISTING RESIDENTIAL

DATA LOG FOR			
DATE	ACTION	REFERENCE DOCUMENTS	REMARKS
	SITE ACQUIRED	RESO NO. _____	ACRES 2.99
	SITE DEDICATED	ORD. NO. _____	ACRES _____
	GDP CONSULTANT HIRE	RESO NO. _____	NAME: AUSTIN-HANSEN GROUP
6-90	P&R BOARD APPROVAL	PF & B APPROVAL	
1-93	INITIAL DEVELOPMENT	CIP NO. 29-713	JO NO. 119403 DRWG NO. 20975-D
		CIP NO. _____	JO NO. _____ DRWG NO. _____
		CIP NO. _____	JO NO. _____ DRWG NO. _____
		CIP NO. _____	JO NO. _____ DRWG NO. _____
		CIP NO. _____	JO NO. _____ DRWG NO. _____

IMPROVEMENTS SUMMARY (DATA FROM AS-BUILT DRAWINGS)			
ITEM	QUANTITY	ITEM	QUANTITY
TOTAL SITE	2.99 AC	PLAY AREA	4,896 SF
IMPROVED AREA	3.23 AC	MULTI PURPOSE CT	SF
TURF	1.84 AC	TENNIS CT'S	SF
GROUNDCOVER	.90 AC	RESTROOM	SF
NATURAL		REC. BLDG	SF
OTHER LANDSCAPING	AC	POOL BLDG	SF
DIRT W/ FIELDS	AC	DECK	SF
PARK SIGN	1 EA	WATER	SF
TRASH RECEPTACLES	5 EA	HOT COAL RECEPTACLES	1 EA
		DRINKING FOUNTAINS	1 EA
		REVISION	TR. 10-17-94

CITY OF SAN DIEGO PARK and RECREATION DEPARTMENT

THE GENERAL DEVELOPMENT PLAN

DEL MAR TRAILS

RENAISSANCE PARK

COUNCIL DIST NO. 1 COMM PLAN AREA NORTH CITY WEST - 24
 LAMBERT COORDINATES 282-1703 THOMAS BROS PG. 1188, C-7
 PSD NO. 190

M-1C

LANDSCAPE ARCHITECTURE
ARCHITECTURE
PLANNING
ENGINEERING



PLANT MATERIAL LEGEND

ASH	FRUITING	FRUITING	FRUITING
...

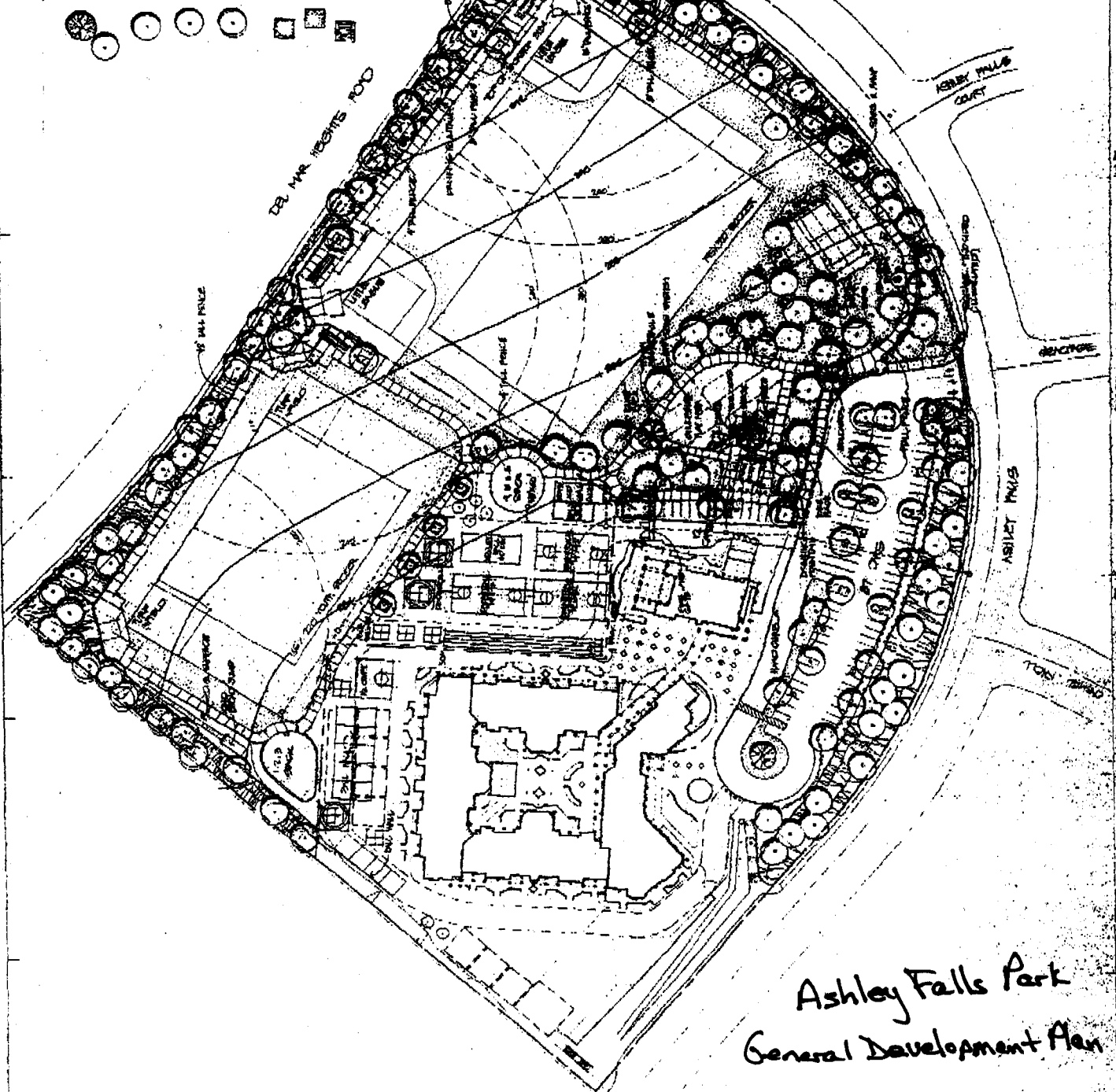

Ashley Falls Park
General Development Plan

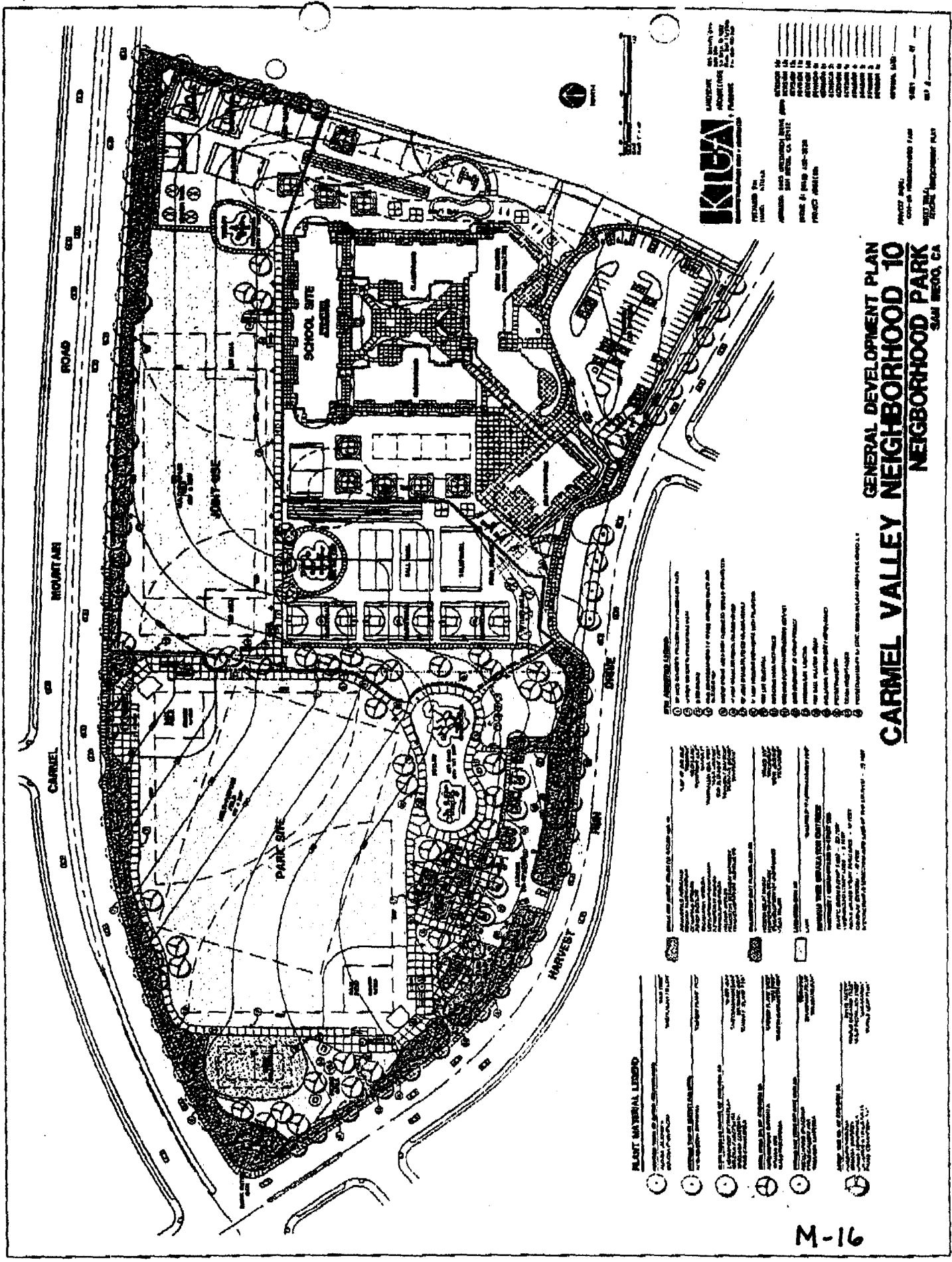

**GENERAL DEVELOPMENT PLAN
NEIGHBORHOOD 10
CARMEL VALLEY PARK
SAN DIEGO, CA**

KIGA
LANDSCAPE ARCHITECTURE
PLANNING

PROJECT NO. 1000000000
DATE: 10/10/00
SCALE: AS SHOWN

OWNER: KIGA
PROJECT: NEIGHBORHOOD 10
CARMEL VALLEY PARK
SAN DIEGO, CA

- PLANT MATERIAL LEGEND**
- 1. PLANT MATERIAL TO BE PLANTED AT THE TIME OF CONSTRUCTION
 - 2. PLANT MATERIAL TO BE PLANTED AT A LATER DATE
 - 3. PLANT MATERIAL TO BE PLANTED AT A LATER DATE - SPECIES TO BE DETERMINED
 - 4. PLANT MATERIAL TO BE PLANTED AT A LATER DATE - SPECIES TO BE DETERMINED
 - 5. PLANT MATERIAL TO BE PLANTED AT A LATER DATE - SPECIES TO BE DETERMINED
 - 6. PLANT MATERIAL TO BE PLANTED AT A LATER DATE - SPECIES TO BE DETERMINED
 - 7. PLANT MATERIAL TO BE PLANTED AT A LATER DATE - SPECIES TO BE DETERMINED
 - 8. PLANT MATERIAL TO BE PLANTED AT A LATER DATE - SPECIES TO BE DETERMINED
 - 9. PLANT MATERIAL TO BE PLANTED AT A LATER DATE - SPECIES TO BE DETERMINED
 - 10. PLANT MATERIAL TO BE PLANTED AT A LATER DATE - SPECIES TO BE DETERMINED

- GENERAL NOTES**
1. ALL DIMENSIONS ARE TO FACE UNLESS OTHERWISE NOTED.
 2. ALL UTILITIES ARE TO BE DEEPER THAN THE FINISH GRADE.
 3. ALL UTILITIES ARE TO BE DEEPER THAN THE FINISH GRADE.
 4. ALL UTILITIES ARE TO BE DEEPER THAN THE FINISH GRADE.
 5. ALL UTILITIES ARE TO BE DEEPER THAN THE FINISH GRADE.
 6. ALL UTILITIES ARE TO BE DEEPER THAN THE FINISH GRADE.
 7. ALL UTILITIES ARE TO BE DEEPER THAN THE FINISH GRADE.
 8. ALL UTILITIES ARE TO BE DEEPER THAN THE FINISH GRADE.
 9. ALL UTILITIES ARE TO BE DEEPER THAN THE FINISH GRADE.
 10. ALL UTILITIES ARE TO BE DEEPER THAN THE FINISH GRADE.